

H Series

METAL JOINTS

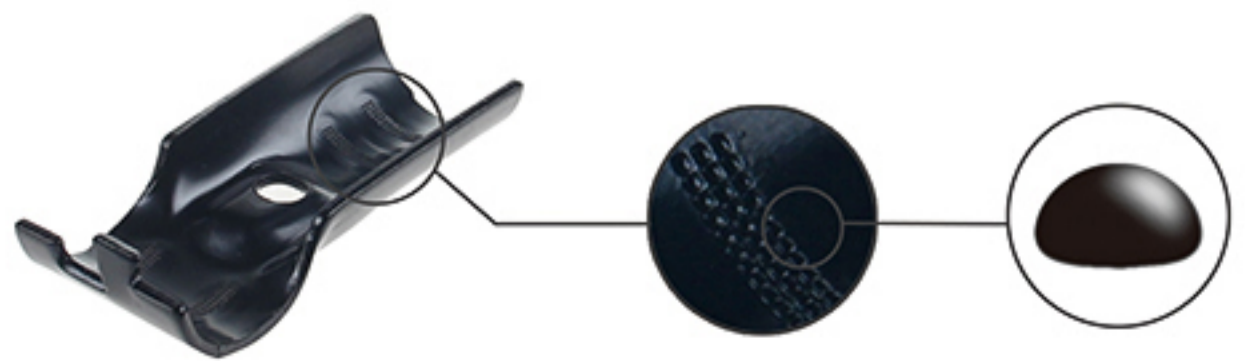

METAL JOINTS



SURFACE : ●BK ○WZ ○NP ○CP ●PC

H-1



kg/Pc	0.067
Pc/Ctn	300

H-1A



kg/Pc	0.058
Pc/Ctn	360

H-2



kg/Pc	0.094
Pc/Ctn	200

H-3 (Ungrip Type)



kg/Pc	0.120
Pc/Ctn	80

H-3K (Grip Type)



kg/Pc	0.120
Pc/Ctn	80

H-4



kg/Pc	0.106
Pc/Ctn	200

H-5



kg/Pc	0.045
Pc/Ctn	300

H-6



kg/Pc	0.059
Pc/Ctn	300

H-6A



kg/Pc	0.066
Pc/Ctn	240

H-7



kg/Pc	0.048
Pc/Ctn	200

H-7A



kg/Pc	0.040
Pc/Ctn	300

H-8



kg/Pc	0.067
Pc/Ctn	240

H-9



kg/Pc	0.062
Pc/Ctn	330

H-10



kg/Pc	0.054
Pc/Ctn	300

H-11



kg/Pc	0.060
Pc/Ctn	280

H-12



kg/Pc	0.063
Pc/Ctn	240

H-13



kg/Pc	0.053
Pc/Ctn	300

H-13A



kg/Pc	0.052
Pc/Ctn	330

H-13B



kg/Pc	0.044
Pc/Ctn	540

H-14



kg/Pc	0.056
Pc/Ctn	320

H-15



kg/Pc	0.038
Pc/Ctn	400

H-16



kg/Pc	0.046
Pc/Ctn	400

H-16A



kg/Pc	0.046
Pc/Ctn	400

H-17



kg/Pc	0.069
Pc/Ctn	220

H-18



kg/Pc	0.069
Pc/Ctn	220

H-19



kg/Pc	0.062
Pc/Ctn	200

H-20



kg/Pc	0.070
Pc/Ctn	200

H-21



kg/Pc	0.133
Pc/Ctn	150

H-23



kg/Pc	0.064
Pc/Ctn	180

H-24



kg/Pc	0.102
Pc/Ctn	200

H-30



kg/Pc	0.062
Pc/Ctn	330

H-45



kg/Pc	0.066
Pc/Ctn	230

H-60



kg/Pc	0.083
Pc/Ctn	150

H-90



kg/Pc	0.102
Pc/Ctn	150

H-110



kg/Pc	0.113
Pc/Ctn	150

H-160



kg/Pc	0.114
Pc/Ctn	160

H-180



kg/Pc	0.071
Pc/Ctn	300



METAL JOINTS (Φ33)

SURFACE : ●BK ○WZ ○NP ○CP ●PC

H-103



kg/Pc	0.073
Pc/Ctn	240

H-403



kg/Pc	0.106
Pc/Ctn	200

H-13C



kg/Pc	0.069
Pc/Ctn	180

H-13D



kg/Pc	0.068
Pc/Ctn	180

METAL JOINTS (Φ28.6)

H-101



kg/Pc	0.078
Pc/Ctn	200

H-102



kg/Pc	0.078
Pc/Ctn	200

H-301



kg/Pc	0.120
Pc/Ctn	80

H-401



kg/Pc	0.108
Pc/Ctn	200

METAL JOINTS (T 2.3)

H-1



kg/Pc	0.061
Pc/Ctn	300

H-2



kg/Pc	0.086
Pc/Ctn	200

H-3 (Ungrip Type)



kg/Pc	0.111
Pc/Ctn	80

H-4



kg/Pc	0.098
Pc/Ctn	200

H-5



kg/Pc	0.042
Pc/Ctn	300

H-6



kg/Pc	0.055
Pc/Ctn	300

H-13A



kg/Pc	0.050
Pc/Ctn	330

H-15



kg/Pc	0.032
Pc/Ctn	400

H-16



kg/Pc	0.042
Pc/Ctn	400

H-17



kg/Pc	0.065
Pc/Ctn	220

H-18



kg/Pc	0.065
Pc/Ctn	220

H-90



kg/Pc	0.095
Pc/Ctn	150

METAL JOINTS (T 2.3 NEW)

H-1



kg/Pc	0.061
Pc/Ctn	300

H-2



kg/Pc	0.086
Pc/Ctn	200

H-3



kg/Pc	0.111
Pc/Ctn	80